

AT A GLANCE

FEATURES

- Stylish top mount control
- Single action design (one lever for throttle one for shift)
- CH5600 patented SLT technology prevents throttle creep
- Superior twin station performance
- Polished stainless steel levers and cover
- Positive detents for shift
- Push or pull to operate throttle and/or shift
- Includes hardware for two 33C type cables
- Optional neutral safety switch

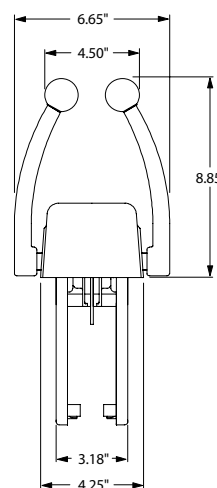
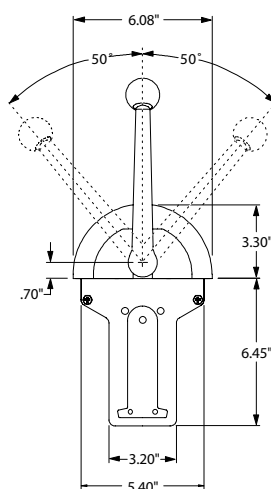

CH5600 TOP MOUNT CONTROLS

TECHNICAL DATA

For single or dual stations with single or twin engines. Using a patented self locking throttle clutch (SLT), the CH5600 control automatically stops throttle creep. Suits 33c type cables.

ORDER INFORMATION	PART NO.
CH5600 SLT top mount control	CH5600P

ACCESSORIES AND PARTS	PART NO.
Optional neutral safety switch	CA69009P
Cable attachment kit (3300/dual sta)	CA69022P
3300 heavy duty brass pivot kit	CA27563P
Replacement red knob	4009912
Replacement black knob	4009819
Stainless steel throttle knob (grooved)	CA69052P**
Stainless steel shift knob (smooth)	CA69051P**
CH5600 mounting hardware kit	CA69013P
Replacement stainless steel lever	CA69060P